

TOOLS	
TOOL NAME	N°

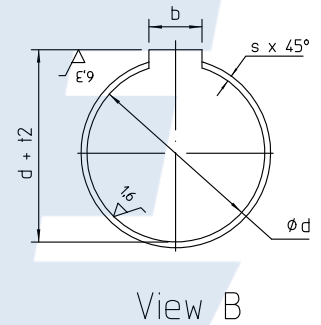

Drive Systems Pty Ltd
 ☎ +61 (0) 3 9796 4800
 ✉ info@drivesystems.com.au
 🏠 8/32 Melverton Drive, Hallam,
 Victoria 3803 Australia
 🌐 drivesystems.com.au
 ABN: 83 836 394 598

Application nominal torque : Nm
 Application peak torque : Nm
 Application nominal speed : rpm
 Application maximum speed : rpm
 Coupling gear max nominal torque capacity : 174000 Nm
 Coupling gear max peak torque capacity : 348000 Nm
 Maximum angular misalignment capacity : 2x0.75 degree
 Bore : min 150 mm
 max 290 mm
 Weight : 413,6 kg
 'J' : 10.872 kg m2
 For assembly, operation and maintenance
 see I.M./B400

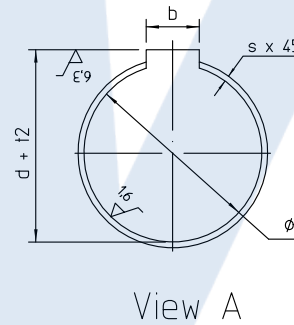
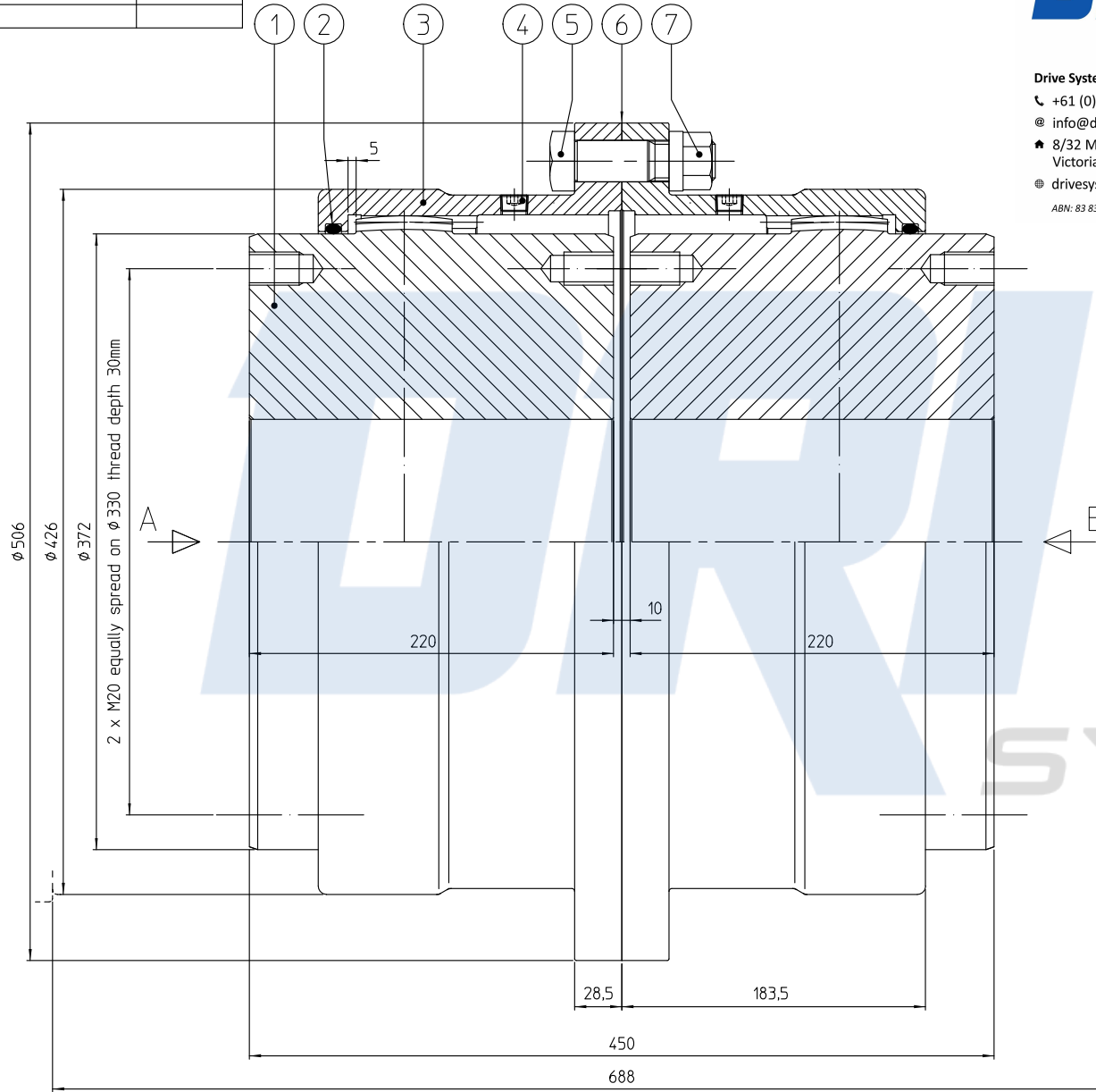

Item	Qty	Designation	Material	Drawing Nr	Code Nr
7	16	Reduced hex. nut	St 12	E-1703	107020.024000.121
6	1	Gasket	Paper	E-1712	449016.275000.006
5	16	Fit bolt	St 12,9	.	101609.024085.124
4	4	Plug	St 5,8	.	104906.706000.050
3	2	Sleeve	9940850-001	E-1709	449016.275000.003
2	2	O-ring	Buna	.	111100.020458.000
1	2	Hub flex	Ck 45	9940850-004	449016.275000.004

Roughness		Inertia (J) :		kg.m2	Weight :	kg	File Nr
Symbol	Ra	Symbol	Scale				
~	µ inch	0	1 / 2				
∇	µ m	1	4cm				
∇∇	252	2					
∇∇∇	63	3					
∇∇∇∇	126	4					
∇∇∇∇∇	32	5					
∇∇∇∇∇∇	63	6					
∇∇∇∇∇∇∇	16	7					
∇∇∇∇∇∇∇∇	0,4	8					

Tolerances : Unless otherwise specified
 Linear : ± 0,1mm
 Angular : ± 0°30'

Drawn : G. H.
 Date : 26-05-2000
 Meth: Concept, AG
 Approved : DPF

ESCO COUPLINGS NV
 Culliganlaan 3 - B 1831 Diegem
 (Brussels) - Belgium
 Web site : www.escocoupling.com

ESCOGEAR FST 275
 Assembly

Format	A 2
Drawing Nr	9940850-000
Rev.	B

REV.	ZONE	REVISION	DATE	NAME
B		Torques 174000 & 348000 were 148000 & 296000	18-04-2001	S. C.
A		Item 7 quality 12 was 10	8-03-2001	D.P.F.