

TOOLS	
TOOL NAME	N°



Drive Systems Pty Ltd

☎ +61 (0) 3 9796 4800

@ info@drivesystems.com.au

📍 8/32 Melverton Drive, Hallam, Victoria 3803 Australia

🌐 drivesystems.com.au

ABN: 83 836 394 598

Application nominal torque : Nm
 Application peak torque : Nm
 Application nominal speed : rpm
 Application maximum speed : rpm
 Coupling gear max nominal torque capacity : 115000 Nm
 Coupling gear max peak torque capacity : 230000 Nm
 Maximum angular misalignment capacity : 2x0.75 degree
 Bore : min 120 mm
 max 244 mm
 Weight : 269,4 kg
 'J' : 5.1557 kg m2
 For assembly, operation and maintenance see I.M./B400

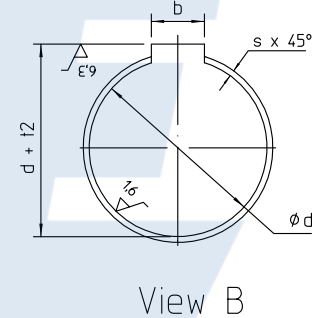
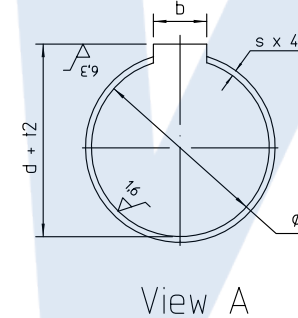
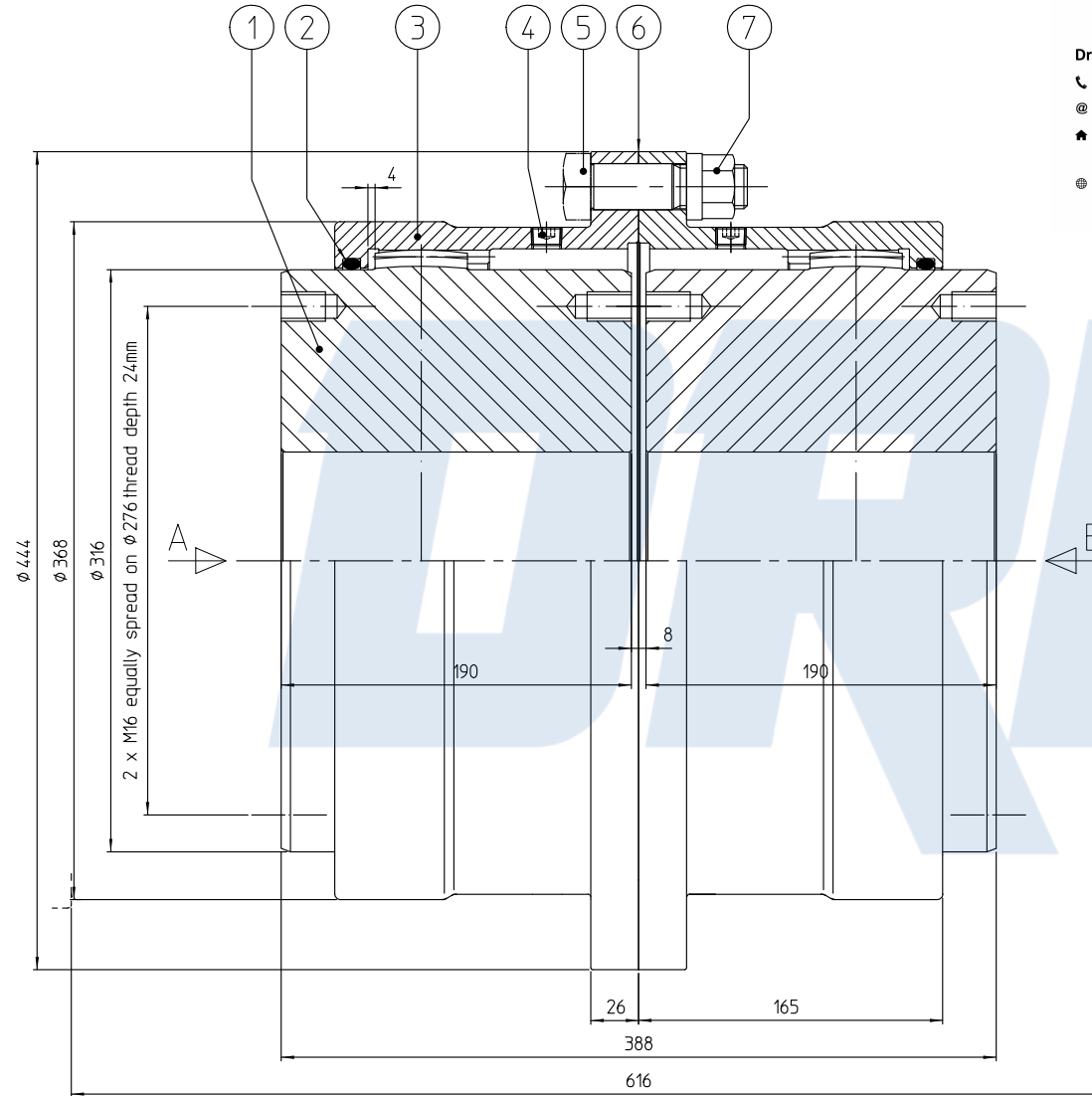

View A

View B

Item	Qty	Designation	Material	Drawing Nr	Code Nr
7	14	Reduced hex. nut	St 12	E-1703	107020.024000.121
6	1	Gasket	Paper	E-1712	449016.240000.006
5	14	Fit bolt	St 12,9	.	101609.024085.124
4	4	Plug	St 5,8	.	104906.706000.050
3	1	Sleeve	9940800-001	E-1709	449016.240000.003
2	2	O-ring	Buna	.	111100.020454.000
1	2	Hub flex	Ck 45	9940800-004	449016.240000.004

Roughness		Inertia (J) :		kg,m2	Weight :	kg	File Nr :
Symbol	Ra	Symbol	Scale	Tolerances : Unless otherwise specified		Drawn	G. H.
~	µ inch	µ m	1 / 2	Linear : * 0,1mm	Date	26-05-2000	n.v. ESCO TRANSMISSIONS s.a.
∇	252	6,3	0 1 2 3 4cm	Angular : * 0°30'	Meth/Concept	AG	Culliganlaan, 3
∇∇	126	3,2		Approved	DPF		1831 DIEGEM - BELGIUM
∇∇∇	63	1,6		This design is the exclusive property of N.V. ESCO TRANSMISSIONS S.A. - DIEGEM. It is for internal use only and is not to be reproduced or to be transmitted to others without written consent.		Tel: 002 7704880 Fax: 002 7212827	
∇∇∇∇	31,5	0,8		ESCOGEAR FST 240 Assembly		Format	A 2
						Drawing Nr	Rev.
						9940800-000	B

REV.	ZONE	REVISION	DATE	NAME
B		Torques 115000 & 230000 were 111000 & 222000	18-04-2001	S. C.
A		Item 7 quality 12 was 10	8-03-2001	D.P.F.